

TYPICAL TORQUE MULTIPLIER CONFIGURATION

FILE UPDATED: 09JUL99

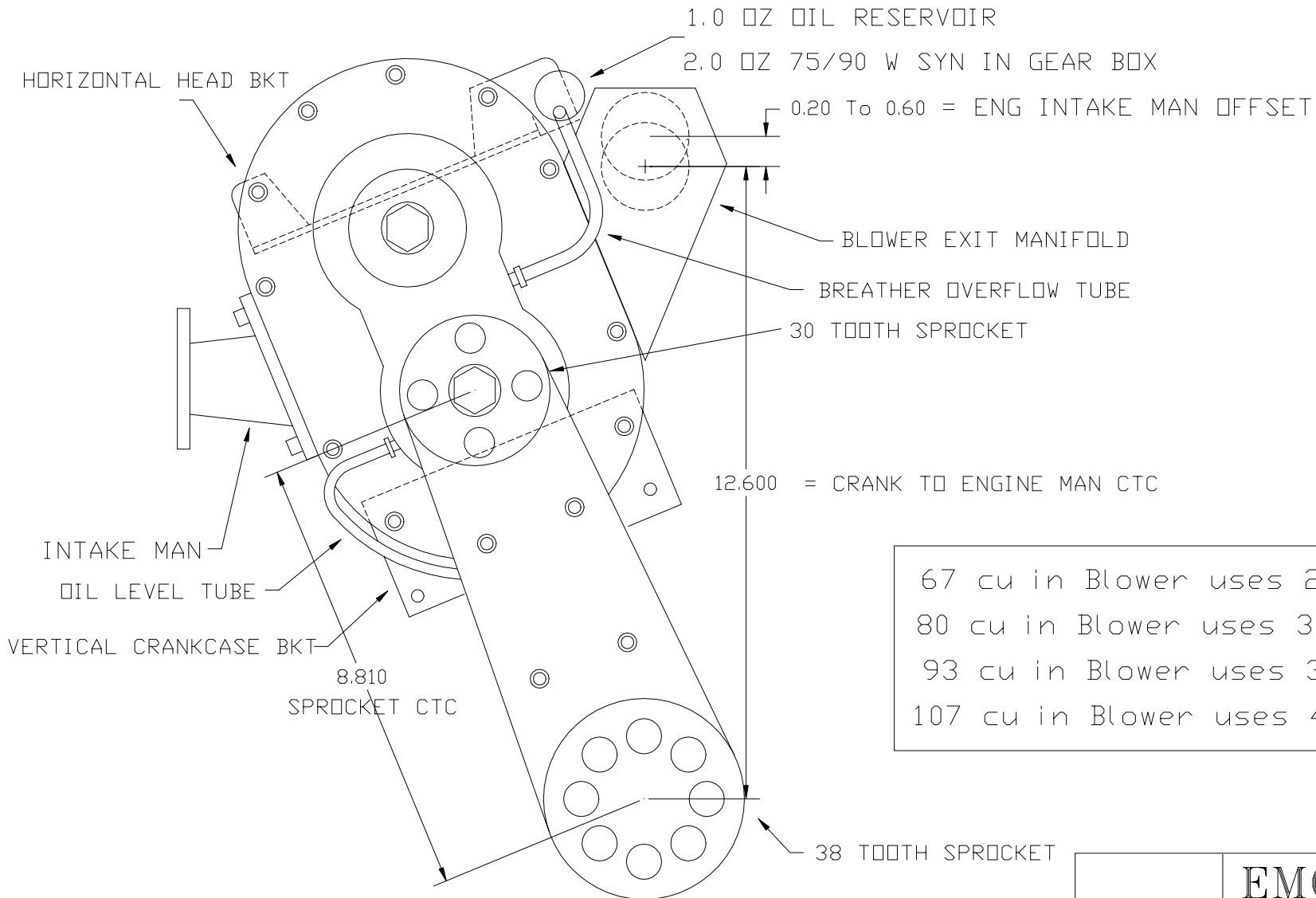

67 cu in Blower uses 2.5 In Rotors
 80 cu in Blower uses 3.0 in Rotors
 93 cu in Blower uses 3.5 in Rotors
 107 cu in Blower uses 4.0 in Rotors

MATERIAL			EMC Eagle Motor Company Cincinnati Oh 45242		
FRAC	DEC	ANG	BLOWER & MOTOR DIM		
1/64	.003	.10			
DRAWN		SHEET NUMBER	DWG #		REV
FWB 19JUN99		1 OF 1	BLWMN22		D
CHECKED					

STOCK H/D EVO WITH 3.5" SUPERCHARGER

93 CU IN / REV

DWG=BLWNT26 A

BLWNT26A 26JAN99

REQ PARTS

- SH10F DRIVE SHAFT
- SL10 INNER SEAL
- SL11 OUTER SEAL
- SL20 EXT .5 SEAL
- SP10 SPACERS (7)

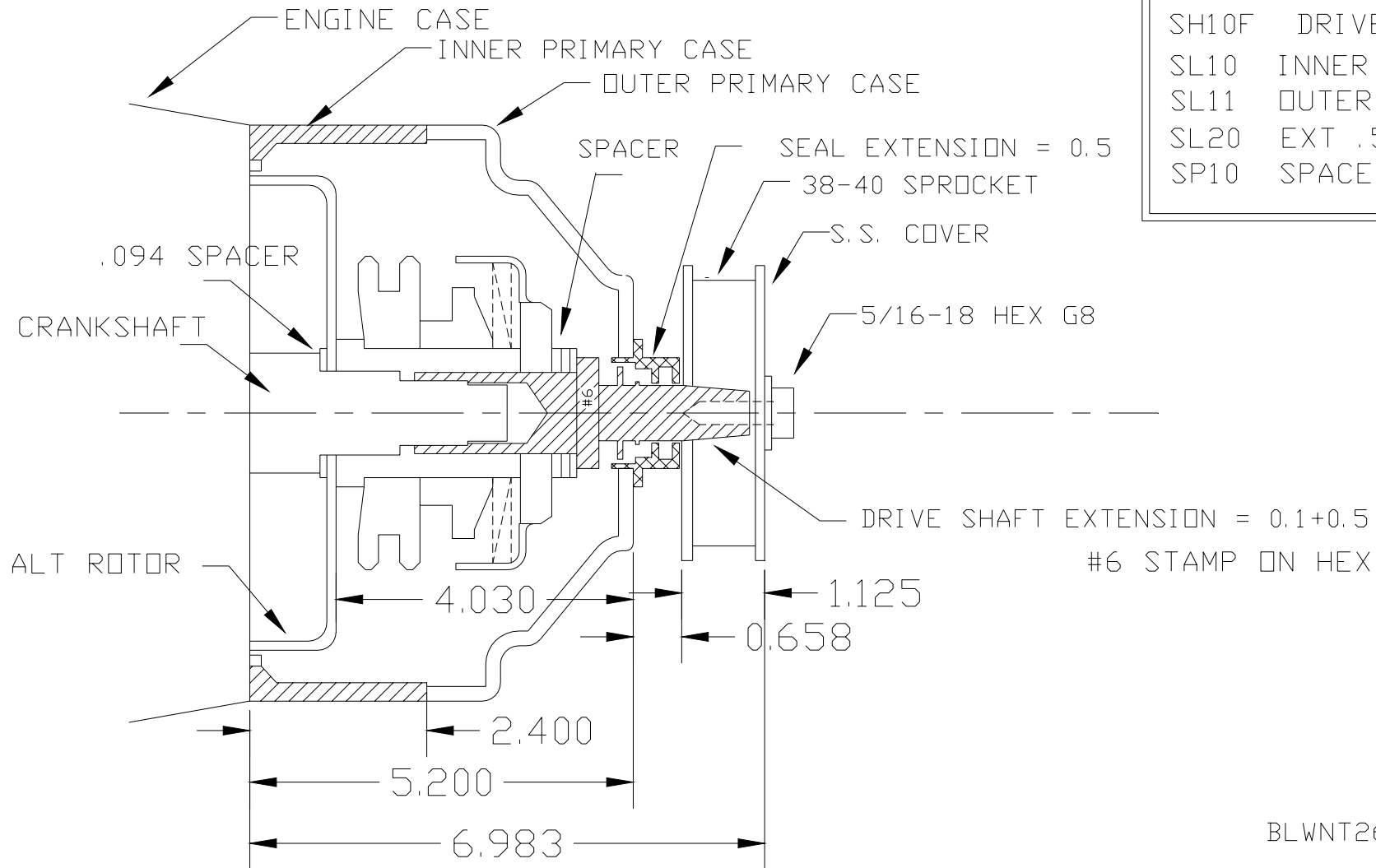

80 cu in EVO H/D PRIMARY CASING

BLWNT26A 26JAN99

MATERIAL		EMC Eagle Motor Company Cincinnati Oh 45242	
FRAC 1/64	DEC .002	ANG XX	80 CU IN EVO H/D PRIMARY
DRAWN FWB	01 JUL 97	SHEET NUMBER 1 OF 1	DWG # BLWNT26 A
CHECKED			REV

DRIVE SHAFT OIL SEAL INSTALLATION

DWG=BLWNT33A

ADD SHIM TO ENSURE OUTER SEAL IS FLUSH WITH COVER
 PRESS THE ALUM SEAL HOUSING WITH HOLE DOWNWARD

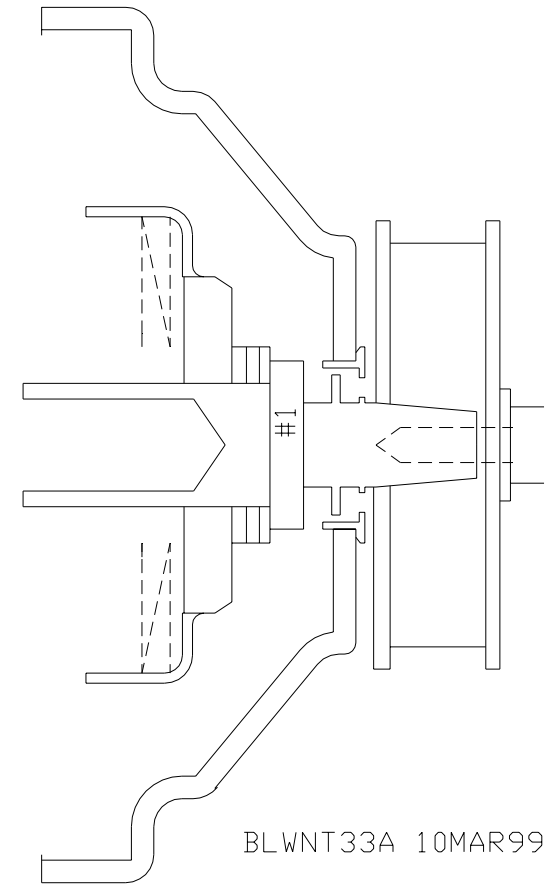
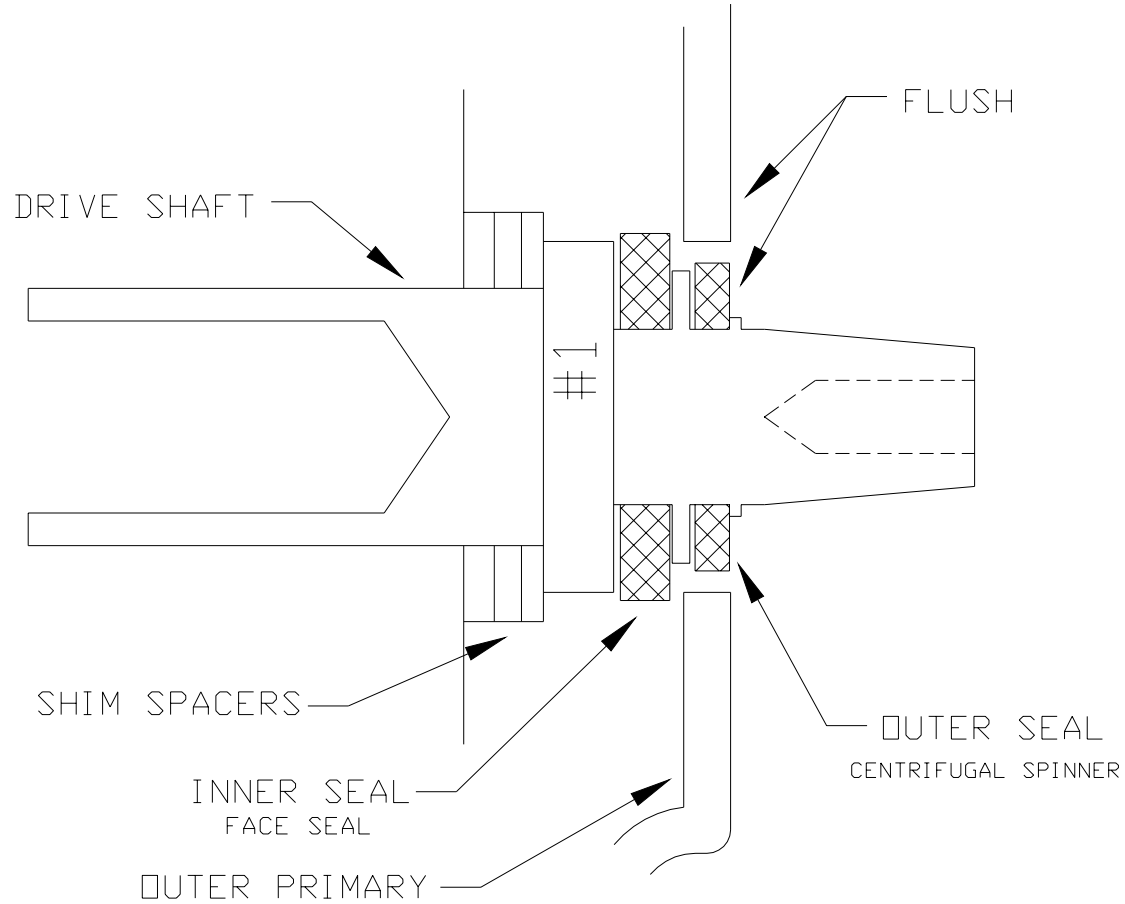

BLWNT33A 10MAR99

MATERIAL		EMC Eagle Motor Company Cincinnati Oh 45237	
FRAC 1/64	DEC .002	ANG XX	DRIVE SEAL SHIMMING
DRAWN FWB	01 JUL 97	SHEET NUMBER 1 OF 1	DWG # BLWNT33 A
CHECKED			REV

PRIMARY OUTPUT DRIVE NUT

DWG=BLWNT64 C

0.8" HEX & EXT NOSE
0.5" Offset Primary

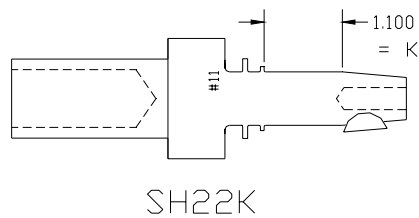
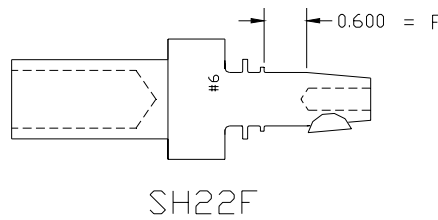
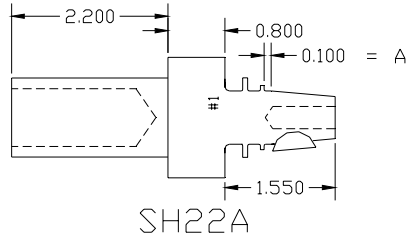

EXTENDED NUT
3.0" Open Primary

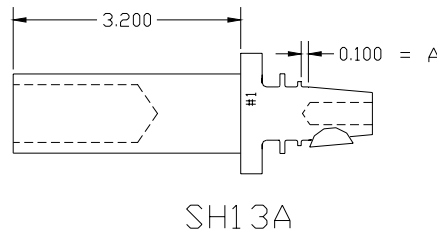
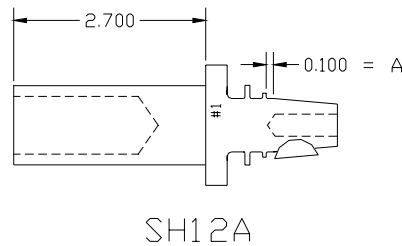
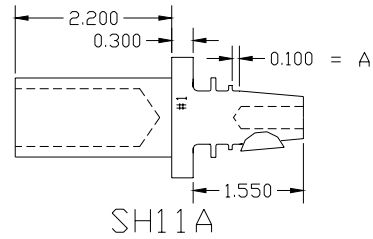

EXTENDED NOSE
.5 & 1" Longer Blower

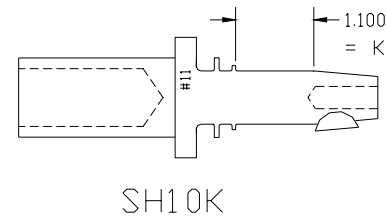
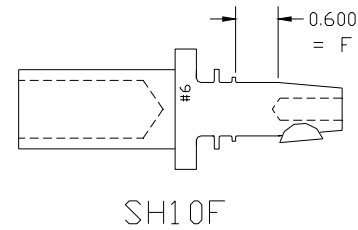
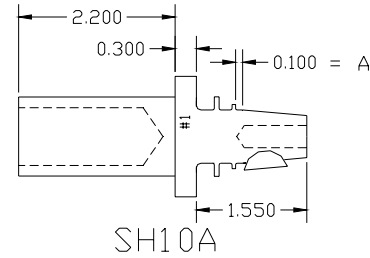

OPTIONAL DRIVES

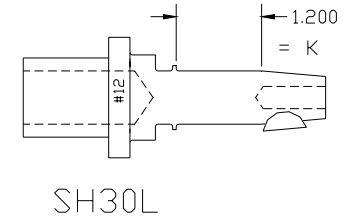
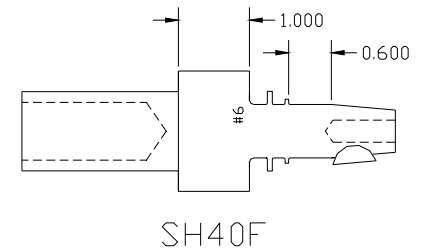

MATERIAL			EMC Eagle Motor Company Cincinnati Oh 45242		
4140					
FRAC	DEC	ANG	V-TWIN DRIVE NUT		
1/64	.002	XX			
DRAWN	29JAN99	SHEET NUMBER	DWG #	REV	
FWB		1 OF 1	BLWNT64 C		
CHECKED					

INTAKE MANIFOLD DIM

BLWMN41E 21JUN99

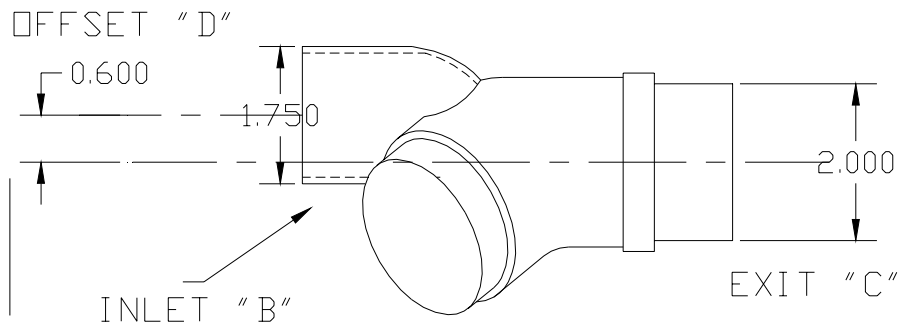
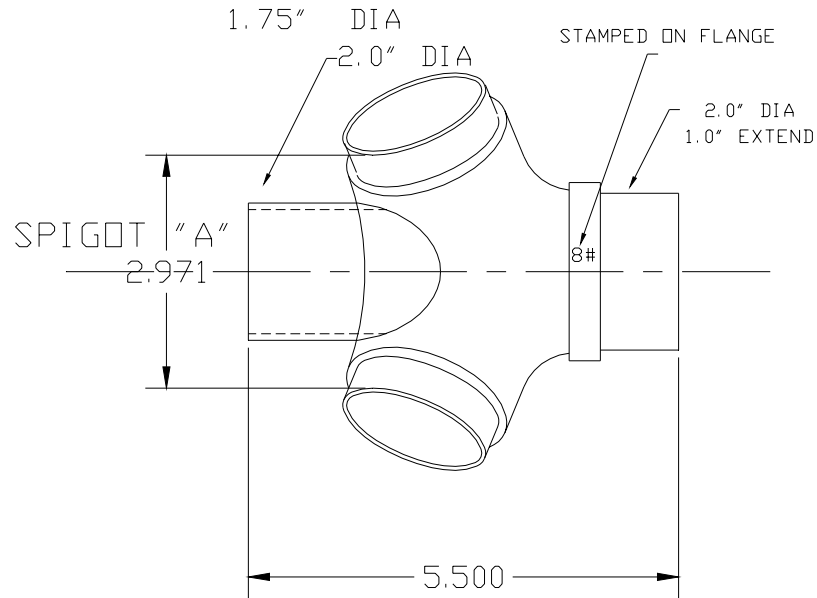

TO BLOWER

TO PLENUM

SPIGOT MIN "A"	INLET IN "B"	EXIT "C"	OFFSET "D"
883 & 1200 SPORTSTER 2.40"	1.75	2.00	0.50
#8 = 80 EVO H/D = 3.10	1.75	2.00	0.20
#9 = 88 TWIN CAM H/D = 3.15	1.75	2.00	0.20
#9 = 94 TWIN CAM H/D = 3.15	2.00	2.00	0.20
#5 = 100 CU IN S&S = 2.95	1.75	2.00	0.60
#6 = 103 CU IN S&S = 3.00	2.00	2.00	0.40
#7 = 113 CU IN S&S = 3.05	2.00	2.00	0.30
#6 = 96 CU IN S&S = 3.00	1.75	2.00	0.20
#6 = 88 CU IN S&S = 3.00	1.75	2.00	0.20
#5 = 120-SHORT MERCH = 2.95	2.00	2.00	0.60
#8 = 120-LONG MERCH = 3.15	2.00	2.00	0.20
#12 = 131 CU IN MERCH = 3.35	2.00	2.00	0.00

			EMC Eagle Motor Company Cincinnati Oh 45237	
MATERIAL	DEC	ANG	INTAKE MANIFOLD DIM	
FRAC	1/64	.003 .10		
DRAWN	FWB	31AUG98	SHEET NUMBER	DWG #
CHECKED			1 OF 2	BLWMN41 E

PLENUM MOUNTING PLATE

DWG=BLWCB34 B

LAST CHANGE: 23JUL99

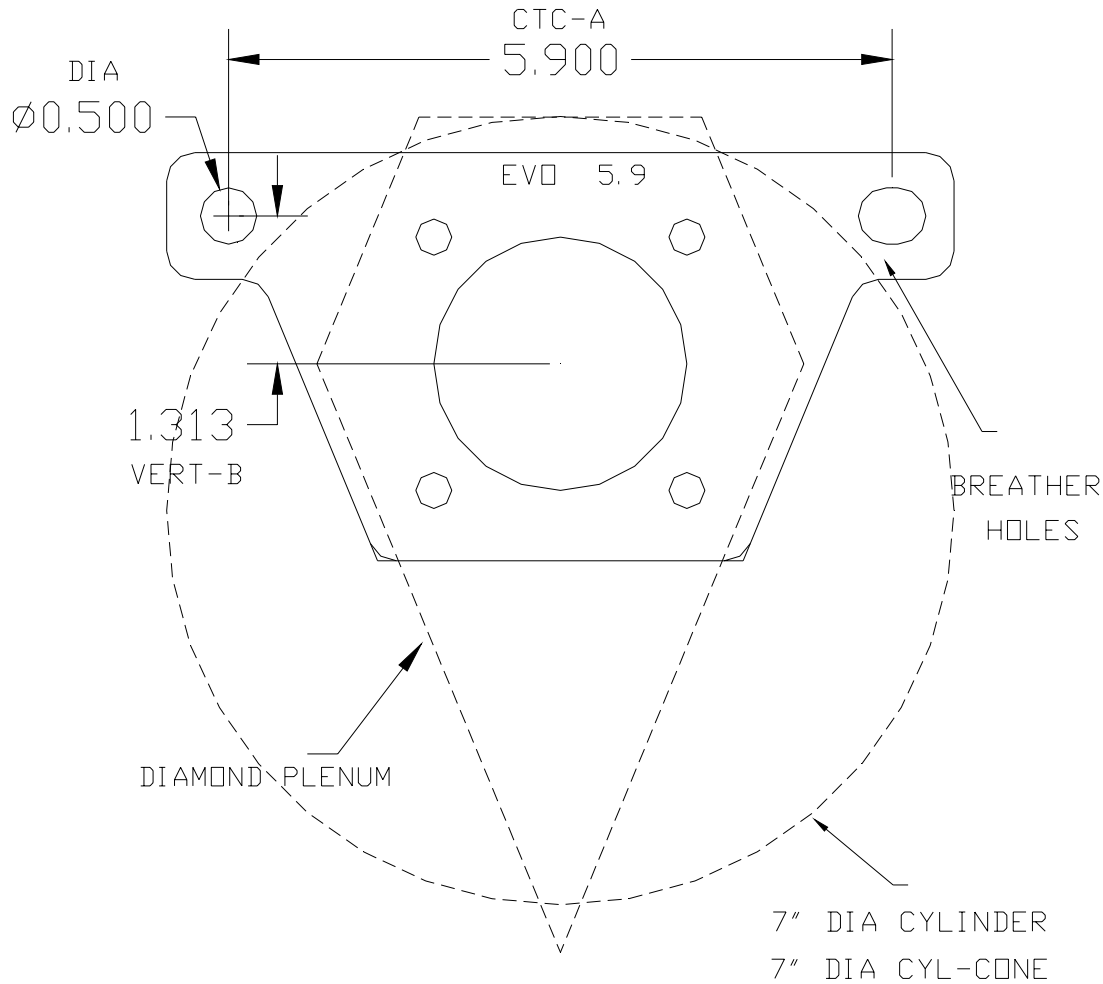

MOTOR TYPE	CTC-A	VERT-B	DIA
883 SPORTSTER	5.20	1.00	0.50
EVD 80 CU IN	5.90	1.31	0.50
TWIN CAM 88-95	5.90	1.31	0.38
S&S 96 CU IN	5.90	1.31	0.50
S&S 100 CU IN	5.70	1.31	0.50
S&S 107 CU IN	5.90	1.31	0.50
S&S 113 CU IN	5.90	1.31	0.50
MERCH 131	6.20	1.31	0.50

MATERIAL: 10 GAUGE .140"

10 Ga SS 304		EMC Eagle Motor Company Cincinnati Oh 45237	
MATERIAL FRAC DEC ANG 1/64 .003 .10		PLENUM MTG PLATE	
DRAWN FWB 19jun99		SHEET NUMBER 1 OF 2	DWG # BLWCB34 B
CHECKED			REV

HORIZONTAL BLW MOUNT & OIL RESERVOIR

BLWBK29 C
23JUL99

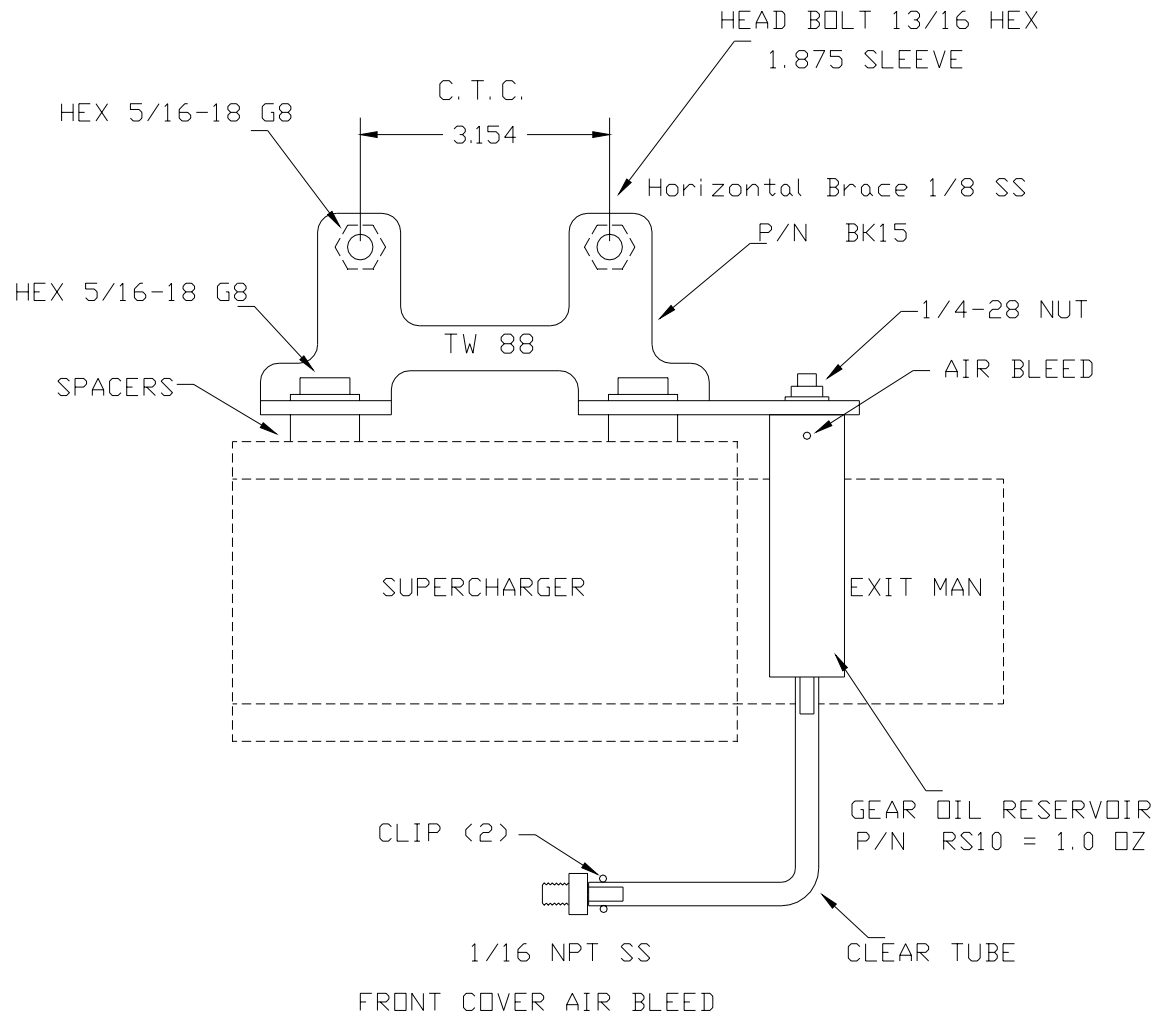

ENGINE HEAD	HD BLT C.T.C.	HEAD BOLT
EVD 80 CU IN H/D	2.933 Inch	1.875 INCH
EVD 883 H/D	2.933 Inch	1.875 INCH
TWIN CAM 88 CU IN	3.154 Inch	1.875 INCH
100,103 S&S	3.220 Inch	1.875 INCH
113 S&S	3.220 Inch	2.375 INCH
4.5 " BORE MERCH	3.600 Inch	1.875 INCH
STD 4.25 SIMMS	3.640 Inch	1.875 INCH
STD-4.0	3.050 Inch	1.875 INCH

Head Bolt C.T.C. Engine Primary Side

MATERIAL			EMC Eagle Motor Company Inc Cincinnati Oh 45237	
FRAC 1/64	DEC .002	ANG XX	BLOWER TO HEAD ASSEM	
DRAWN FWB	24MAY99	CHECKED	SHEET NUMBER 1 OF 1	DWG # BLWBK29 C
			REV	

12 JUL 99

SPACER DIMENSIONS

SPACERS DIM FOR VARIOUS MOTORS

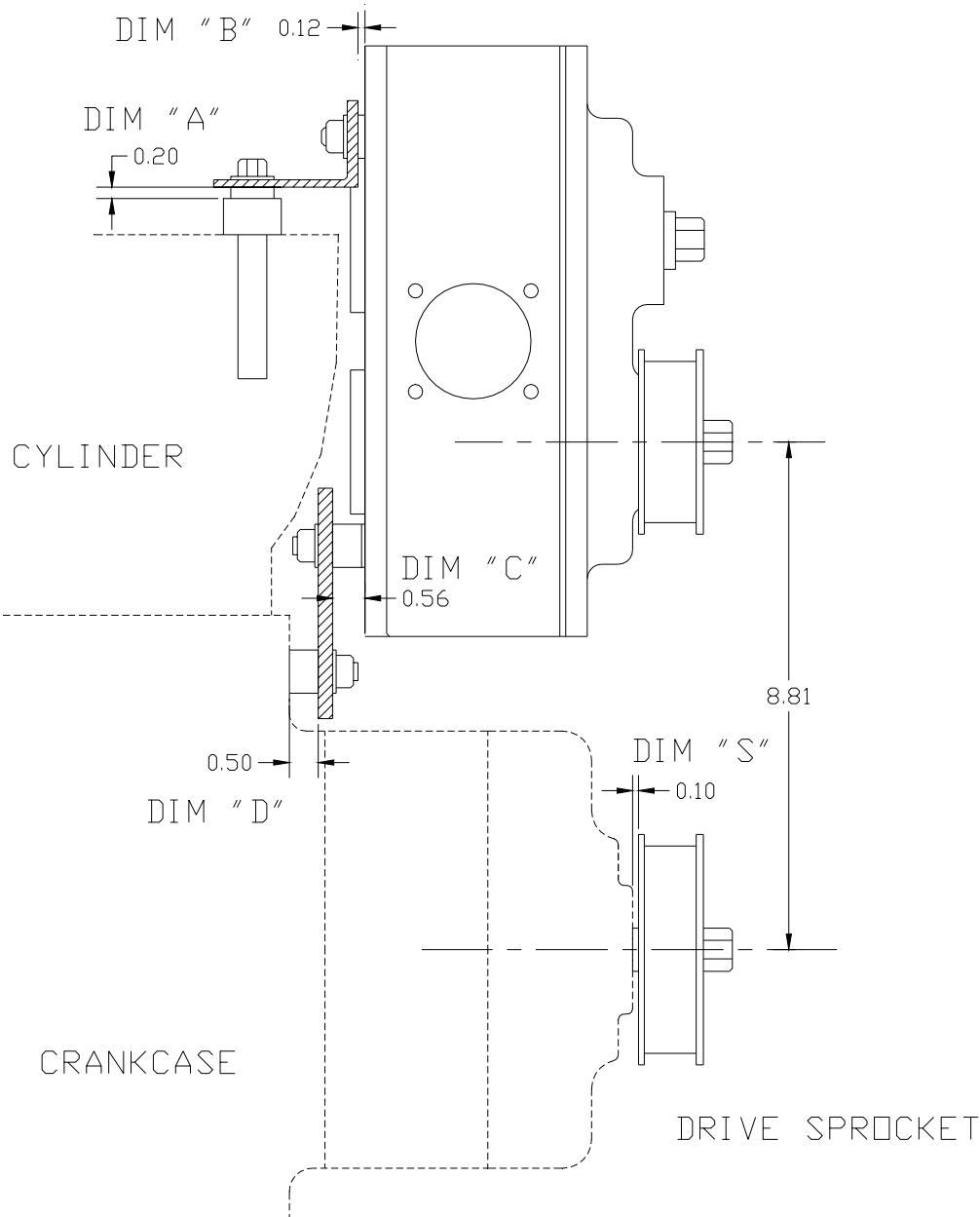

MOTOR SIZE	BLW	DIM-A	DIM-B	DIM-C	DIM-D	DIM-S
80 CU IN EVD	67	.20	.50	1.0	0.5	0.1
80 CU IN EVD	80	.20	0.0	0.5	0.5	0.1
88-95 TWIN CAM	67	0.12	0.5	0.7	1.2	0.2
88-95 TWIN CAM	80	0.12	0.5	0.7	1.2	0.7
883-1200 SPOTSTER	67	0.3	0.0	0.5	1.0	1.2
96 CU IN S&S	80	DIM-A	DIM-A	DIM-A	DIM-A	DIM-A
100 CU IN S&S	80	DIM-A	DIM-A	DIM-A	DIM-A	DIM-A
103 CU IN S&S	80	DIM-A	DIM-A	DIM-A	DIM-A	DIM-A
113 CU IN S&S	93	DIM-A	DIM-A	DIM-A	DIM-A	DIM-A
120 CU IN MERCH	93	DIM-A	DIM-A	DIM-A	DIM-A	DIM-A
131 CU IN MERCH	107	DIM-A	DIM-A	DIM-A	DIM-A	DIM-A
ENGINE SIZE	DIM-A	DIM-A	DIM-A	DIM-A	DIM-A	DIM-A

			CCDI Cincinnati Control Dynamics Inc Cincinnati Oh 45237		
MATERIAL FRAC DEC ANG 1/64 .003 .10			SPACER DIMENSIONS		
DRAWN FWB 10 OCT 97		SHEET NUMBER 1 OF 1		DWG # BLWDIM1A	
CHECKED			REV		

